

Distribution block

Push-in

Temperature range: -20°C to
max. +70°C

Operating pressure: up to max.
18 bar

Vacuum:
-99

DB

Verdeelblok

Manifold

Distributeur

Verteiler

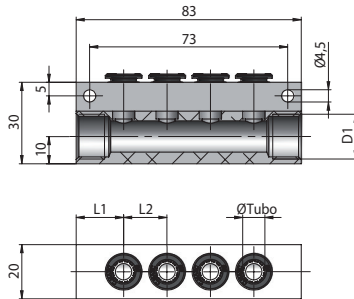

Type	$\varnothing \text{ Tubo}$	D_1	L1	L2	N°	$g \Delta \Delta$
DB04 14TL	4	G1/4	14	11	6	111,7
DB06 14TL	6	G1/4	15,5	13	5	104,1
DB08 38TL	8	G3/8	17,5	16	4	99,3